

要注意

- シリンダアダプタ内径寸法(★印)を MAX φ95 に設計して下さい
- ブラケット取り付け位置を変更する時は、リングも反時計回りに 90° 回転させて取り付けて下さい

NOTE

- Design the inner dia.(mark ★) of cylinder adapter should be max.φ95
- When changing of bracket set position, ring also should be set after rotating with 90 degree CCW.

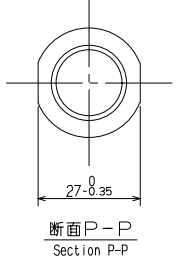

SPECIFICATIONS	
PISTON DIA	110 mm
PISTON STROKE	20 mm
PISTON THRUST	PUSH 28 kN (AT 3.5 MPa) PULL 27 kN
MAX. OPERATING PRESSURE	3.5 MPa
MAX. SPEED	6000 min ⁻¹
MASS	8.3 kg
MOMENT OF INERTIA	0.016 kg·m ²
PROXIMITY SWITCH	B&PLUS BE5516-325-E3R
OIL LEAKAGE	ISO VG 32, 50°C, 3.0MPa 1.2 0/min

CAREER	SCALE	TYPE	M1120HC21N	WEIGHT	kg
MANAGER	CHIEF	DRAWN BY	NAME	M1120HC21N	OUTSIDE VIEW
KITAGAWA IRON WORKS CO.,LTD.	DATE	3RD ANGLE	DRW NO.	61R255434	1/1