

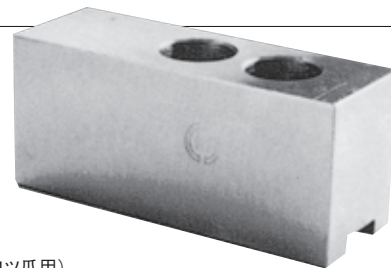

CHUCK

パワーチャック用ソフトジョー Soft Jaws for Power Chuck SB series



型式表示 Description of Model

SB06A1-80

- ジョーの全高を示す。標準ジョーには表示はありません。
Total jaw height. The height of standard jaw is not displayed.
- 1セットの数を表す。 - = 3ヶ (3ツ爪用) T = 2ヶ (2ツ爪用) Q = 4ヶ (4ツ爪用)
Number of jaws for 1 set - = 3 pcs. (for 3 jaws) T = 2 pcs. (for 2 jaws) Q = 4 pcs. (for 4 jaws)
- セレーションピッチを表す。 1=1.5mm×60°, 2=3mm×60°
Serration pitch 1=1.5mm×60°, 2=3mm×60°
- 形状、特徴を表す。
A = 山取りなし、B = 山取りあり、L = 軽量型、N = 新型
C = ジョー取付ボルトピッチ区分 (同チャック径で異なる場合)
中空4" = 15mm、中空5" = 18mm 12" チャック = 38mm 15" チャック = 43mm
D = DL用
Form and characteristic
A = Non cut of crest B = Cut of crest L = Light weight N = New type
C = Bolt spacing classification (In case spacing is different at same chuck dia.)
Hollow 4" = 15mm, hollow 5" = 18mm 12" chuck = 38mm 15" chuck = 43mm
D = for DL series
- チャックサイズを表す。Chuck sizes
- パワーチャックソフトジョーを表す。Power chuck soft jaw

■ ソフトジョー兼用表 Combination of Soft Jaws ※ ()内のチャック型式は旧型式です。 ※Chuck models in parentheses are discontinued models.

| 標準爪型式 Standard jaw | 高爪型式 High jaw | 適応中実チャック型式 Adaptive closed centre chuck | 適応中空チャック型式 Adaptive open centre chuck |
|-----------------------|------------------------------------|---|--|
| SB04C1 | SB04C1-036, SB04C1-048 | | (B-04, HOB-4) |
| SB04C1T | SB04C1T048 | | (BT04, HOBT-4) |
| SB04B1 | SB04A1-036, SB04A1-048 | N-04 (HJ-4), AS04, NL04, NRC04 | |
| SB04A1T | SB04A1T048 | NT04, AT04 | |
| SB04N1 | SB04N1-036, SB04N1-048 | | B-204 |
| SB04N1T | | | BT204 |
| SB05C1 | SB05C1-038, SB05C1-053 | | (B-05, HOB-5) |
| SB05C1T | SB05C1T053 | | (BT05, HOBT-5) |
| SB05B1 | SB05A1-038, SB05A1-053 | N-05 (HJ-5) | |
| SB05A1T | SB05A1T053 | NT05 | |
| SB05N1 | SB05N1-038, SB05N1-053 | | B-205 |
| SB05N1T | | | BT205 |
| SB06B1 | SB06A1-066 | N-06, NL06, AS06, NRC06, (HJA5-6) | BB206, B-06 (HOB-6, HOS-6, HO-6, HOH-06K, BB06) |
| SB06A1T | SB06A1T066 | NT06, NLTO6, AT06 | (BT06, HOBT-6) |
| SB06C1 | | (HT-6) | UVE160K |
| SB06D1 | | DL206 (DL06) | |
| SB06L1A | | | BS306, B-206, HOH-206, BL206 |
| SB06L1T | | | BT206 |
| SB08B1 | SB08A1-056, SB08A1-076 | N-08, NL08, AS08, NRC08, DL208 (DL08), (HJA6-8) | BB208, BS308, B-208, HOH-208, BL208, B-08 (HOB-8, HOS-8, HO-8, HOH-08K, BB08) |
| SB08B1Q | SB08B1Q-76 | HW-08 | |
| SB08A1T | SB08A1T056, SB08A1T076 | NT08, NLTO8, AT08 | BT208, (BT08, HOBT-8) |
| SB10A1 | SB10A1-056, SB10A1-080, SB10A1-116 | NL10, AS10, NRC10 | |
| SB10B1 | | N-10, (HJA6-8-10) | BB210, BS310, B-210, BL210, B-10, (HOB-10, HOS-10, HO-10, HOH-10K, UVE200K, UVE250K) |
| SB10A2Q | SB10A2Q080 | HW-10, 12 | |
| SB10A2 | SB10A2-080 | (HJ-10) | |
| SB10A1T | SB10A1T080 | NT10, NLTO10, AT10 | BT210, (BT10, HOBT-10) |
| SB10D1 | | DL210 (DL10) | |
| SB12A1 | SB12A1-090 | N-12, NL12, DL212 (DL12), (HJA6-8-12) | B-12, (HOB-12, HOS-12), HOH-12K |
| SB12C1 | | | UVE315K, (HO-12) |
| SB12A1T | SB12A1T090 | NT12, NLTO12 | (BT12, HOBT-12) |
| SB12N1 | SB12N1-090 | | BB212, B-212, BL212 |
| SB12N1T | | | BT212, BLT212 |
| SB15C1 | SB15C1-110 | | B-15-18, (HOB-15-18, HO-15, HOS-15), HOH-15K |
| SB15A1 | SB15A1-110 | (HJA8-15-18-21, HJA11-15) | |
| SB15A2 | | (HJ-15) | UVE400K |
| SB15A2Q | | HW-15 | |
| SB15C1T | | | (BT15, HOBT-15) |
| SB15N1 | SB15N1-110 | N-15, N-18 | B-215 |
| UVE500AR | | | (UVE500AR) |
| SB18A2 | SB18A2-110 | N-21, N-24, (HJ-18-21, HJA11-18-21) | B-21-24, (HOB-21-24, UVE500K-630K, UVE560AR-630AR, UVE500L, UVE630L, UVE500LB, UVE630LB) |
| SB24A2 | SB24A2-130 | (HJA11-24, HJ-24) | (UVE800K, UVE750AR, UVE800LB) |
| SB06BB | SB06BB-040 | | QB306, (QB206) |
| SB08BB | SB08BB-056 | | QB308, (QB208) |
| SB10BB | SB10BB-060 | | QB310, (QB210) |
| SB12BB | SB12BB-070 | | QB312, (QB212) |
| SBW06 | | PW-06 | |
| SBW08 | | PW-08 | |
| SBW10 | | PW-10 | |
| SBW12 | | PW-12 | |
| SBW15 | | PW-15 | |

■ 標準ソフトジョー組合せ表
Combination Table for Standard Soft Jaws

| チャック型式 Chuck | ソフトジョー型式 Soft jaw | チャック型式 Chuck | ソフトジョー型式 Soft jaw |
|-----------------|----------------------|-----------------|----------------------|
| B-204 | SB04N1 | N-04 | SB04B1 |
| B-205 | SB05N1 | N-05 | SB05B1 |
| B-206 | SB06L1A | N-06 | SB06B1 |
| B-208 | SB08B1 | N-08 | SB08B1 |
| B-210 | SB10B1 | N-10 | SB10B1 |
| B-212 | SB12N1 | N-12 | SB12A1 |
| B-215 | SB15N1 | N-15 | SB15N1 |
| | | N-18 | SB15N1 |
| B-04 | SB04C1 | N-21 | SB18A2 |
| B-05 | SB05C1 | N-24 | SB18A2 |
| B-06 | SB06B1 | | |
| B-08 | SB08B1 | NL04 | SB04B1 |
| B-10 | SB10B1 | NL06 | SB06B1 |
| B-12 | SB12A1 | NL08 | SB08B1 |
| B-15 | SB15C1 | NL10 | SB10A1 |
| B-18 | SB15C1 | NL12 | SB12A1 |
| B-21 | SB18A2 | | |
| B-24 | SB18A2 | NT04 | SB04A1T |
| | | NT05 | SB05A1T |
| BB206 | SB06B1 | NLT06 | SB06A1T |
| BB208 | SB08B1 | NLT08 | SB08A1T |
| BB210 | SB10B1 | NLT10 | SB10A1T |
| BB212 | SB12N1 | NLT12 | SB12A1T |
| BB06 | SB06B1 | | |
| BB08 | SB08B1 | HW-08 | SB08B1Q |
| | | HW-10 | SB10A2Q |
| BS306 | SB06L1A | HW-12 | SB10A2Q |
| BS308 | SB08B1 | HW-15 | SB15A2Q |
| BS310 | SB10B1 | | |
| | | UVE160K | SB06C1 |
| BL206 | SB06L1A | UVE200K | SB10B1 |
| BL208 | SB08B1 | UVE250K | SB10B1 |
| BL210 | SB10B1 | UVE315K | SB12C1 |
| BL212 | SB12N1 | UVE400K | SB15A2 |
| | | UVE500LB | SB18A2 |
| HOH-206 | SB06L1A | UVE500AR | UVE500AR |
| HOH-208 | SB08B1 | UVE630LB | SB18A2 |
| HOH-10K | SB10B1 | UVE630AR | SB18A2 |
| HOH-12K | SB12A1 | UVE750AR | SB24A2 |
| HOH-15K | SB15C1 | UVE800LB | SB24A2 |
| | | | |
| QB306 | SB06BB | UB450K | UB450 |
| QB308 | SB08BB | UB560K | UB560K |
| QB310 | SB10BB | UB630K | UB710 |
| QB312 | SB12BB | UB710K | UB710 |
| | | | |
| BT204 | SB04N1T | DL206 | SB06D1 |
| BT205 | SB05N1T | DL208 | SB08B1 |
| BT206 | SB06L1T | DL210 | SB10D1 |
| BT208 | SB08A1T | DL212 | SB12A1 |
| BT210 | SB10A1T | DL06 | SB06D1 |
| BT212 | SB12N1T | DL08 | SB08B1 |
| BT-04 | SB04C1T | DL10 | SB10D1 |
| BT-05 | SB05C1T | DL12 | SB12A1 |
| BT-06 | SB06A1T | | |
| BT-08 | SB08A1T | | |
| BT-10 | SB10A1T | | |
| BT-12 | SB12A1T | | |
| BT-15 | SB15C1T | | |

■ 標準ソフトジョー組合せ表
Combination Table for Standard Soft Jaws

| チャック型式 Chuck | ソフトジョー型式 Soft jaw | チャック型式 Chuck | ソフトジョー型式 Soft jaw |
|-----------------|----------------------|-----------------|----------------------|
| PW-06 | SBW06 | AT04 | SB04A1T |
| PW-08 | SBW08 | AT06 | SB06A1T |
| PW-10 | SBW10 | AT08 | SB08A1T |
| PW-12 | SBW12 | AT10 | SB10A1T |
| PW-15 | SBW15 | | |
| | | NRC04 | SB04B1 |
| AS04 | SB04B1 | NRC06 | SB06B1 |
| AS06 | SB06B1 | NRC08 | SB08B1 |
| AS08 | SB08B1 | NRC10 | SB10B1 |
| AS10 | SB10A1 | | |

■ 高爪適用表
Interchangeable High jaws with standard jaws

| 標準爪型式 Standard jaw | 高爪型式 High jaw |
|-----------------------|------------------------------------|
| SB04C1 | SB04C1-036, SB04C1-048 |
| SB04C1T | SB04C1T048 |
| SB04B1 | SB04A1-036, SB04A1-048 |
| SB04A1T | SB04A1T048 |
| SB04N1 | SB04N1-036, SB04N1-048 |
| | |
| SB05C1 | SB05C1-038, SB05C1-053 |
| SB05C1T | SB05C1T053 |
| SB05B1 | SB05A1-038, SB05A1-053 |
| SB05A1T | SB05A1T053 |
| SB05N1 | SB05N1-038, SB05N1-053 |
| | |
| SB06B1 | SB06A1-066 |
| SB06A1T | SB06A1T066 |
| | |
| SB08B1 | SB08A1-056, SB08A1-076 |
| SB08B1Q | SB08B1Q-76 |
| SB08A1T | SB08A1T056, SB08A1T076 |
| | |
| SB10B1 (A1) | SB10A1-056, SB10A1-080, SB10A1-116 |
| SB10A2Q | SB10A2Q080 |
| SB10A2 | SB10A2-080 |
| SB10A1T | SB10A1T080 |
| | |
| SB12A1 | SB12A1-090 |
| SB12A1T | SB12A1T090 |
| SB12N1 | SB12N1-090 |
| | |
| SB15A1 | SB15A1-110 |
| SB15C1 | SB15C1-110 |
| SB15N1 | SB15N1-110 |
| | |
| SB18A2 | SB18A2-110 |
| | |
| SB24A2 | SB24A2-130 |
| | |
| SB06BB | SB06BB-040 |
| SB08BB | SB08BB-056 |
| SB10BB | SB10BB-060 |
| SB12BB | SB12BB-070 |

参考図1 Ref. DWG. 1

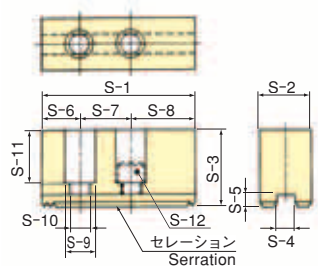

参考図2 Ref. DWG. 2

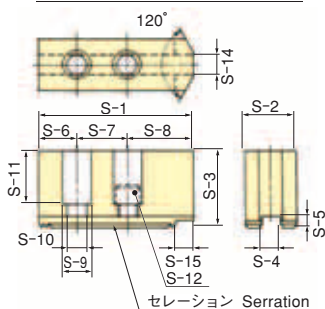

参考図3 Ref. DWG. 3

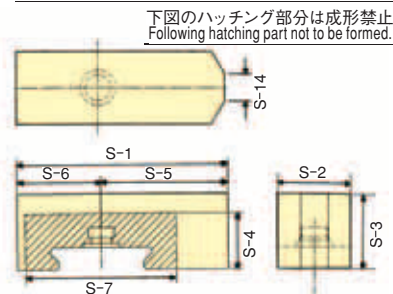

■ ソフトジョー寸法表 Dimensions

| ソフトジョー型式 Soft Jaw TYPE | S-1 | S-2 | S-3 | S-4 | S-5 | S-6 | S-7 | S-8 | S-9 | S-10 | S-11 | S-12 | S-14 | S-15 | セレーションピッチ Serration pitch | 参考図 Ref. DWG. |
|---------------------------|-------|-----|------|------|-----|------|-----|-------|------|------|------|------|------|------|------------------------------|------------------|
| SB04C1 | 48 | 19 | 23 | 8 | 3 | 8 | 15 | 25 | 11 | 6.6 | 15 | M6 | 6 | | 1.5×60° | 2 |
| SB04C1-036 | 48 | 19 | 36 | 8 | 3 | 8 | 15 | 25 | 11 | 6.6 | 28 | M6 | | | 1.5×60° | 1 |
| SB04C1-048 | 48 | 19 | 48 | 8 | 3 | 8 | 15 | 25 | 11 | 6.6 | 40 | M6 | | | 1.5×60° | 1 |
| SB04C1T | 48 | 19 | 23 | 8 | 3 | 8 | 15 | 25 | 11 | 6.6 | 15 | M6 | | | 1.5×60° | 1 |
| SB04C1T048 | 48 | 19 | 48 | 8 | 3 | 8 | 15 | 25 | 11 | 6.6 | 40 | M6 | | | 1.5×60° | 1 |
| SB04B1 | 55 | 23 | 25 | 10 | 4 | 13 | 14 | 28 | 13.5 | 8.5 | 16 | M8 | 3 | 13 | 1.5×60° | 2 |
| SB04A1-036 | 55 | 23 | 36 | 10 | 4 | 13 | 14 | 28 | 13.5 | 8.5 | 27 | M8 | | | 1.5×60° | 1 |
| SB04A1-048 | 55 | 23 | 48 | 10 | 4 | 13 | 14 | 28 | 13.5 | 8.5 | 39 | M8 | | | 1.5×60° | 1 |
| SB04A1T | 55 | 23 | 25 | 10 | 4 | 13 | 14 | 28 | 13.5 | 8.5 | 16 | M8 | | | 1.5×60° | 1 |
| SB04A1T048 | 55 | 23 | 48 | 10 | 4 | 13 | 14 | 28 | 13.5 | 8.5 | 39 | M8 | | | 1.5×60° | 1 |
| SB04N1 | 49.5 | 23 | 23 | 10 | 4 | 10 | 14 | 25.5 | 13.5 | 8.5 | 14.5 | M8 | 4 | | 1.5×60° | 2 |
| SB04N1T | 49.5 | 23 | 23 | 10 | 4 | 10 | 14 | 25.5 | 13.5 | 8.5 | 14.5 | M8 | | | 1.5×60° | 1 |
| SB04N1-036 | 49.5 | 23 | 36 | 10 | 4 | 10 | 14 | 25.5 | 13.5 | 8.5 | 27.5 | M8 | | | 1.5×60° | 1 |
| SB04N1-048 | 49.5 | 23 | 48 | 10 | 4 | 10 | 14 | 25.5 | 13.5 | 8.5 | 39.5 | M8 | | | 1.5×60° | 1 |
| SB05C1 | 57 | 23 | 31 | 10 | 3 | 10 | 18 | 29 | 13.5 | 8.5 | 22 | M8 | 12 | | 1.5×60° | 2 |
| SB05C1-038 | 57 | 23 | 38 | 10 | 3 | 10 | 18 | 29 | 13.5 | 8.5 | 29 | M8 | | | 1.5×60° | 1 |
| SB05C1-053 | 57 | 23 | 53 | 10 | 3 | 10 | 18 | 29 | 13.5 | 8.5 | 44 | M8 | | | 1.5×60° | 1 |
| SB05C1T | 57 | 23 | 31 | 10 | 3 | 10 | 18 | 29 | 13.5 | 8.5 | 22 | M8 | | | 1.5×60° | 1 |
| SB05C1T053 | 57 | 23 | 53 | 10 | 3 | 10 | 18 | 29 | 13.5 | 8.5 | 44 | M8 | | | 1.5×60° | 1 |
| SB05B1 | 62 | 23 | 27 | 10 | 4 | 14 | 19 | 29 | 13.5 | 8.5 | 18 | M8 | 12 | 14 | 1.5×60° | 2 |
| SB05A1-038 | 62 | 23 | 38 | 10 | 4 | 14 | 19 | 29 | 13.5 | 8.5 | 29 | M8 | | | 1.5×60° | 1 |
| SB05A1-053 | 62 | 23 | 53 | 10 | 4 | 14 | 19 | 29 | 13.5 | 8.5 | 44 | M8 | | | 1.5×60° | 1 |
| SB05A1T | 62 | 23 | 27 | 10 | 4 | 14 | 19 | 29 | 13.5 | 8.5 | 18 | M8 | | | 1.5×60° | 1 |
| SB05A1T053 | 62 | 23 | 53 | 10 | 4 | 14 | 19 | 29 | 13.5 | 8.5 | 44 | M8 | | | 1.5×60° | 1 |
| SB05N1 | 54 | 23 | 25 | 10 | 4 | 12 | 14 | 28 | 13.5 | 8.5 | 16.5 | M8 | 5 | | 1.5×60° | 2 |
| SB05N1T | 54 | 23 | 25 | 10 | 4 | 12 | 14 | 28 | 13.5 | 8.5 | 16.5 | M8 | | | 1.5×60° | 1 |
| SB05N1-038 | 54 | 23 | 38 | 10 | 4 | 12 | 14 | 28 | 13.5 | 8.5 | 29.5 | M8 | | | 1.5×60° | 1 |
| SB05N1-053 | 54 | 23 | 53 | 10 | 4 | 12 | 14 | 28 | 13.5 | 8.5 | 44.5 | M8 | | | 1.5×60° | 1 |
| SB06B1 | 72 | 31 | 32 | 12 | 5 | 15 | 20 | 37 | 17 | 11 | 20 | M10 | 12 | 15 | 1.5×60° | 2 |
| SB06A1-066 | 72 | 31 | 66 | 12 | 5 | 15 | 20 | 37 | 17 | 11 | 54 | M10 | | | 1.5×60° | 1 |
| SB06A1T | 72 | 31 | 32 | 12 | 5 | 15 | 20 | 37 | 17 | 11 | 20 | M10 | | | 1.5×60° | 1 |
| SB06A1T066 | 72 | 31 | 66 | 12 | 5 | 15 | 20 | 37 | 17 | 11 | 54 | M10 | | | 1.5×60° | 1 |
| SB06C1 | 76.5 | 40 | 37 | 14 | 5 | 15 | 25 | 36.5 | 19 | 13 | 22 | M12 | | | 1.5×60° | 1 |
| SB06D1 | 72 | 31 | 32 | 12 | 5 | 22 | 20 | 30 | 17 | 11 | 20 | M10 | 6 | 15 | 1.5×60° | 2 |
| SB06L1A | 66 | 26 | 28 | 12 | 5 | 12 | 20 | 34 | 17 | 11 | 16 | M10 | 5 | 12 | 1.5×60° | 2 |
| SB06L1T | 66 | 26 | 28 | 12 | 5 | 12 | 20 | 34 | 17 | 11 | 16 | M10 | | | 1.5×60° | 1 |
| SB08B1 | 95 | 35 | 38 | 14 | 5 | 24 | 25 | 46 | 19 | 13 | 23 | M12 | 12 | 20 | 1.5×60° | 2 |
| SB08A1-056 | 95 | 35 | 56 | 14 | 5 | 24 | 25 | 46 | 19 | 13 | 41 | M12 | | | 1.5×60° | 1 |
| SB08A1-076 | 95 | 35 | 76 | 14 | 5 | 24 | 25 | 46 | 19 | 13 | 61 | M12 | | | 1.5×60° | 1 |
| SB08B1Q | 90 | 31 | 38 | 12 | 5 | 24 | 20 | 46 | 17 | 11 | 26 | M10 | 16 | 24 | 1.5×60° | 2 |
| SB08B1Q-76 | 90 | 31 | 76 | 12 | 5 | 24 | 20 | 46 | 17 | 11 | 64 | M10 | 16 | 24 | 1.5×60° | 2 |
| SB08A1T | 95 | 35 | 38 | 14 | 5 | 24 | 25 | 46 | 19 | 13 | 23 | M12 | | | 1.5×60° | 1 |
| SB08A1T056 | 95 | 35 | 56 | 14 | 5 | 24 | 25 | 46 | 19 | 13 | 41 | M12 | | | 1.5×60° | 1 |
| SB08A1T076 | 95 | 35 | 76 | 14 | 5 | 24 | 25 | 46 | 19 | 13 | 61 | M12 | | | 1.5×60° | 1 |
| UB450 | 165 | 62 | 66 | 25.5 | 8 | 37 | 43 | 85 | 32 | 21 | 43 | M20 | | | 3.0×60° | 1 |
| UB560K | 180 | 65 | 69.2 | 25.5 | 8 | 39.5 | 60 | 80.5 | 32 | 21 | 45.3 | M20 | | | 3.0×60° | 1 |
| UB710 | 209.5 | 75 | 80 | 30 | 9 | 40 | 60 | 109.5 | 39 | 26 | 55 | M24 | | | 3.0×60° | 1 |

参考図4 Ref. DWG. 4

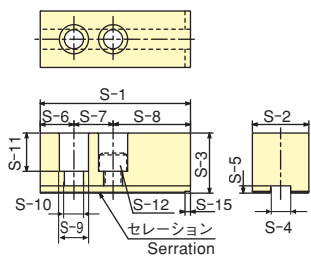

参考図5 Ref. DWG. 5

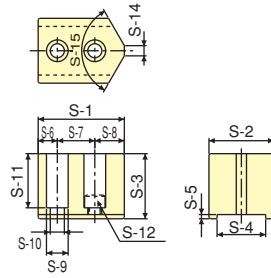

参考図1、2、4 セレシオン部詳細
Ref. DWG. 1, 2, 4 Serration

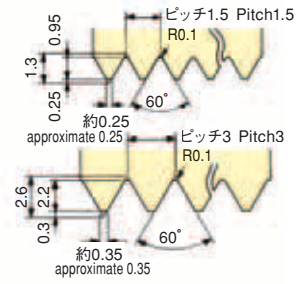

■ ソフトジョー寸法表 Dimensions

| ソフトジョー型式 Soft Jaw TYPE | S-1 | S-2 | S-3 | S-4 | S-5 | S-6 | S-7 | S-8 | S-9 | S-10 | S-11 | S-12 | S-14 | S-15 | セレシオンピッチ Serration pitch | 参考図 Ref. DWG. |
|---------------------------|-------|------|-------|-------|-----|------|-------|-------|-----|------|------|------|------|------|-----------------------------|------------------|
| SB10B1 | 110 | 40 | 42 | 16 | 5 | 30 | 30 | 50 | 19 | 13 | 27 | M12 | 15 | 20 | 1.5×60° | 2 |
| SB10A1 | 110 | 40 | 42 | 16 | 5 | 30 | 30 | 50 | 19 | 13 | 27 | M12 | | | 1.5×60° | 1 |
| SB10A1-056 | 110 | 40 | 56 | 16 | 5 | 30 | 30 | 50 | 19 | 13 | 41 | M12 | | | 1.5×60° | 1 |
| SB10A1-080 | 110 | 40 | 80 | 16 | 5 | 30 | 30 | 50 | 19 | 13 | 65 | M12 | | | 1.5×60° | 1 |
| SB10A1-116 | 110 | 40 | 116 | 16 | 5 | 30 | 30 | 50 | 19 | 13 | 101 | M12 | | | 1.5×60° | 1 |
| SB10A2Q | 110 | 40 | 42 | 16 | 6 | 30 | 30 | 50 | 19 | 13 | 26 | M12 | | | 3.0×60° | 1 |
| SB10A2Q080 | 110 | 40 | 80 | 16 | 6 | 30 | 30 | 50 | 19 | 13 | 64 | M12 | | | 3.0×60° | 1 |
| SB10A2 | 110 | 40 | 42 | 16 | 6 | 30 | 30 | 50 | 19 | 13 | 26 | M12 | | | 3.0×60° | 1 |
| SB10A2-080 | 110 | 40 | 80 | 16 | 6 | 30 | 30 | 50 | 19 | 13 | 65 | M12 | | | 3.0×60° | 1 |
| SB10A1T | 110 | 40 | 42 | 16 | 5 | 30 | 30 | 50 | 19 | 13 | 27 | M12 | | | 1.5×60° | 1 |
| SB10A1T080 | 110 | 40 | 80 | 16 | 5 | 30 | 30 | 50 | 19 | 13 | 65 | M12 | | | 1.5×60° | 1 |
| SB10D1 | 101.5 | 45 | 45 | 18 | 5 | 22.5 | 30 | 49 | 22 | 15 | 25 | M14 | 15 | 17.5 | 1.5×60° | 2 |
| SB12A1 | 129 | 50 | 50 | 18 | 5 | 39 | 30 | 60 | 22 | 15 | 30 | M14 | | | 1.5×60° | 1 |
| SB12A1-090 | 129 | 50 | 90 | 18 | 5 | 39 | 30 | 60 | 22 | 15 | 70 | M14 | | | 1.5×60° | 1 |
| SB12C1 | 129 | 50 | 50 | 18 | 5 | 32 | 38 | 59 | 22 | 15 | 35 | M14 | | | 1.5×60° | 1 |
| SB12A1T | 129 | 50 | 50 | 18 | 5 | 39 | 30 | 60 | 22 | 15 | 30 | M14 | | | 1.5×60° | 1 |
| SB12A1T090 | 129 | 50 | 90 | 18 | 5 | 39 | 30 | 60 | 22 | 15 | 70 | M14 | | | 1.5×60° | 1 |
| SB12N1 | 111 | 50 | 50 | 21 | 4 | 21 | 30 | 60 | 25 | 17 | 33 | M16 | | | 1.5×60° | 1 |
| SB12N1-090 | 111 | 50 | 90 | 21 | 4 | 21 | 30 | 60 | 25 | 17 | 73 | M16 | | | 1.5×60° | 1 |
| SB12N1T | 111 | 50 | 50 | 21 | 4 | 21 | 30 | 60 | 25 | 17 | 33 | M16 | | 6 | 1.5×60° | 1 |
| SB15C1 | 165 | 62 | 66 | 22 | 8 | 37 | 43 | 85 | 32 | 21 | 42 | M20 | | 6 | 1.5×60° | 4 |
| SB15C1-110 | 165 | 62 | 110 | 22 | 8 | 37 | 43 | 85 | 32 | 21 | 86 | M20 | | | 1.5×60° | 4 |
| SB15A1 | 156 | 62 | 70 | 22 | 8 | 36 | 60 | 60 | 32 | 21 | 45 | M20 | | | 1.5×60° | 1 |
| SB15A1-110 | 156 | 62 | 110 | 22 | 8 | 36 | 60 | 60 | 32 | 21 | 85 | M20 | | | 1.5×60° | 1 |
| SB15A2 | 156 | 62 | 70 | 22 | 9 | 36 | 60 | 60 | 32 | 21 | 45 | M20 | | | 3.0×60° | 1 |
| SB15A2Q | 129 | 50 | 50 | 18 | 6 | 32 | 38 | 59 | 22 | 15 | 34 | M14 | | 6 | 3.0×60° | 1 |
| SB15C1T | 165 | 62 | 66 | 22 | 8 | 37 | 43 | 85 | 32 | 21 | 42 | M20 | | | 1.5×60° | 4 |
| SB15N1 | 135 | 50 | 60 | 25.5 | 5 | 26 | 43 | 66 | 32 | 21 | 39 | M20 | | | 1.5×60° | 1 |
| SB15N1-110 | 135 | 50 | 110 | 25.5 | 5 | 26 | 43 | 66 | 32 | 21 | 89 | M20 | | | 1.5×60° | 1 |
| UVE500AR | 210 | 65 | 100 | 25 | 9 | 40 | 60 | 110 | 32 | 21 | 75 | M20 | | | 3.0×60° | 1 |
| SB18A2 | 180 | 65 | 70 | 25 | 9 | 40 | 60 | 80 | 32 | 21 | 45 | M20 | | | 3.0×60° | 1 |
| SB18A2-110 | 180 | 65 | 110 | 25 | 9 | 40 | 60 | 80 | 32 | 21 | 85 | M20 | | | 3.0×60° | 1 |
| SB24A2 | 210 | 75 | 90 | 25 | 9 | 40 | 80 | 90 | 32 | 21 | 65 | M20 | | | 3.0×60° | 1 |
| SB24A2-130 | 210 | 75 | 130 | 25 | 9 | 40 | 80 | 90 | 32 | 21 | 105 | M20 | | | 3.0×60° | 1 |
| SB06BB | 90 | 32 | 30 | 24 | 54 | 36 | 68 | | | | | | | 5 | | 3 |
| SB06BB-040 | 90 | 32 | 40 | 24 | 54 | 36 | 68 | | | | | | | 5 | | 3 |
| SB08BB | 106 | 37 | 38 | 28 | 64 | 42 | 76 | | | | | | | 14 | | 3 |
| SB08BB-056 | 106 | 37 | 56 | 28 | 64 | 42 | 76 | | | | | | | 14 | | 3 |
| SB10BB | 125 | 42 | 42 | 31 | 76 | 49 | 88 | | | | | | | 26 | | 3 |
| SB10BB-060 | 125 | 42 | 60 | 31 | 76 | 49 | 88 | | | | | | | 26 | | 3 |
| SB12BB | 139 | 42 | 50 | 34 | 90 | 49 | 92 | | | | | | | 30 | | 3 |
| SB12BB-070 | 139 | 42 | 70 | 34 | 90 | 49 | 92 | | | | | | | 30 | | 3 |
| PW-06 | 67.5 | 50.8 | 51 | 38.07 | 3.3 | 15 | 29.36 | 23.14 | 17 | 11 | 42.4 | M10 | 8 | 120° | | 5 |
| PW-08 | 74 | 57 | 57.47 | 44.45 | 3.3 | 15 | 34.14 | 24.86 | 20 | 13.5 | 47 | M12 | 41 | 90° | | 5 |
| PW-10 | 89.5 | 70.1 | 70.2 | 57.1 | 3.3 | 19 | 44.45 | 26.05 | 25 | 17 | 59 | M16 | | | | 5 |
| PW-12 | 108.5 | 70.1 | 70.2 | 57.1 | 3.3 | 19 | 44.45 | 45.05 | 25 | 17 | 59 | M16 | | | | 5 |
| PW-15 | 140 | 76.2 | 76.5 | 66.62 | 3.3 | 23.9 | 53.98 | 62.12 | 32 | 21 | 61.2 | M20 | | | | 5 |